

DARLINGTON SCHOOLHOUSE

For the
New York-New Jersey Trail Conference
156 Ramapo Valley Road, Mahwah, NJ 07430

COLGAN PERRY LAWLER AURELL ARCHITECTS

118 MAIN STREET
TAPPAN, NEW YORK 10983
845-680-6670 INFO@CPLARCH.COM



Arthur R. Breuer, PE, PLLC
24 North Greeley Avenue, Chappaqua, NY 10514
(Phone) 914-238-5433 (Fax) 914-238-4472
(Email) arbpe@arbpe.com

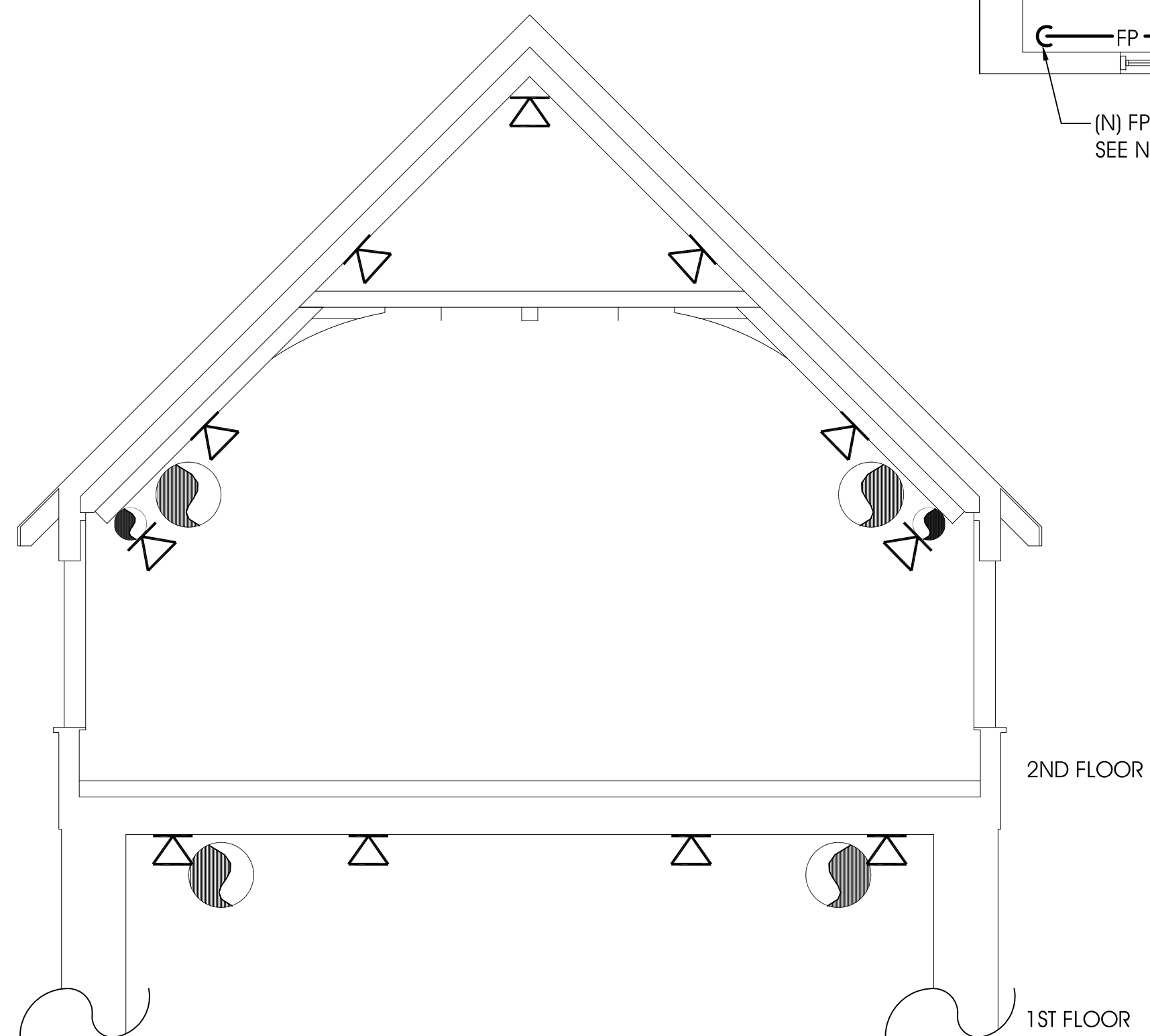
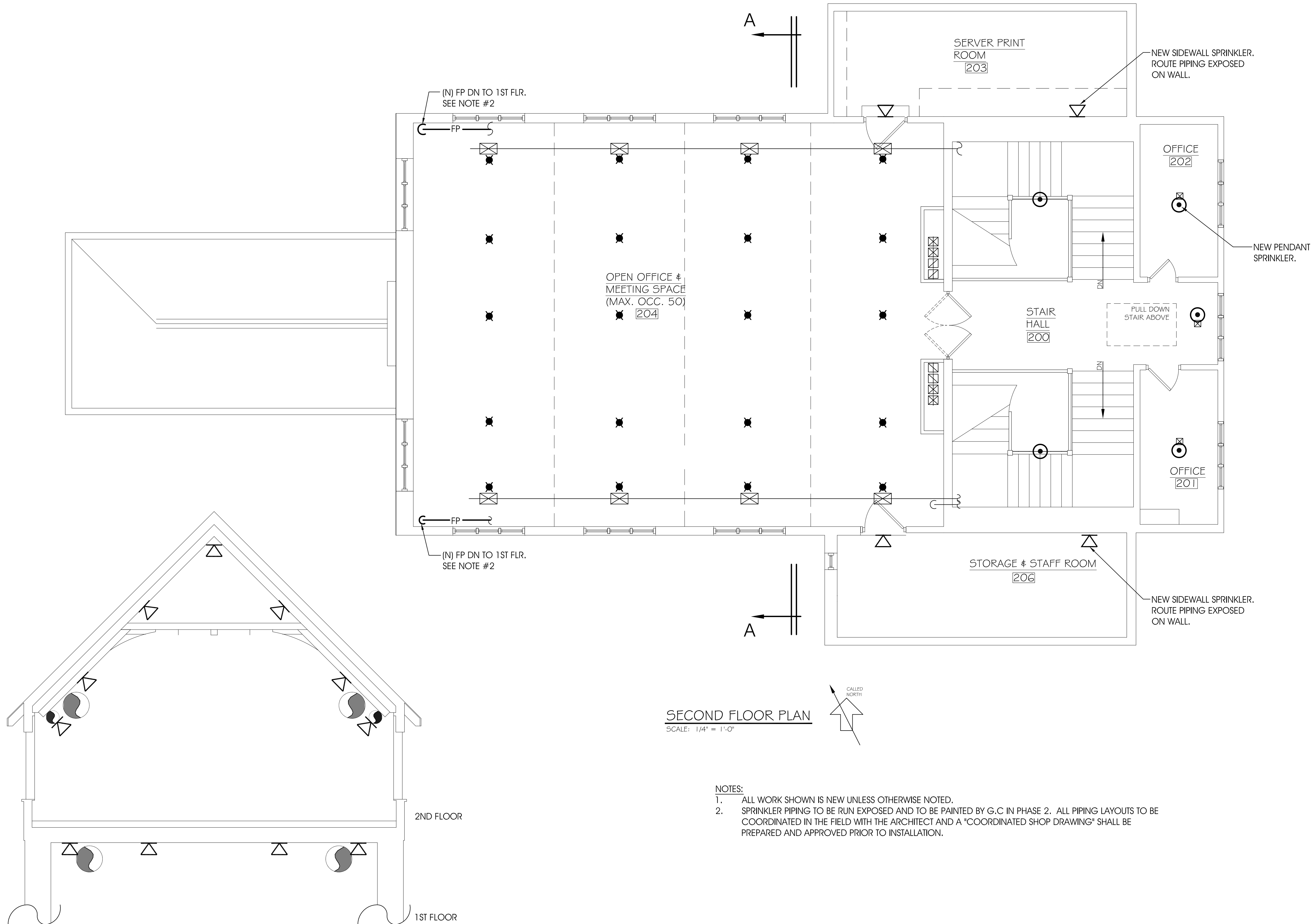

SECOND FLOOR PLAN
SCALE: 1/4" = 1'-0"

- NOTES:
1. ALL WORK SHOWN IS NEW UNLESS OTHERWISE NOTED.
 2. SPRINKLER PIPING TO BE RUN EXPOSED AND TO BE PAINTED BY G.C IN PHASE 2. ALL PIPING LAYOUTS TO BE COORDINATED IN THE FIELD WITH THE ARCHITECT AND A "COORDINATED SHOP DRAWING" SHALL BE PREPARED AND APPROVED PRIOR TO INSTALLATION.

SECTION A-A
SCALE: 1/4" = 1'-0"

ALL WORK ON THIS DRAWING IS IN AN ALTERNATE BID AND IS NOT IN BASE BID.

DATE	JUNE 14, 2010
DRAWN BY	VP
CHECKED BY	RHB
JOB NO.	ARBPE 3052
FIRE PROTECTION: SECOND FLOOR PLAN - NEW WORK	FP-4